

# MINUTEMAN II & WHEELMAN II 5 cu. ft. Portable MultiMixers

The Minuteman and Wheelman continue to reign as the “World’s Finest Portable Concrete Mixers”. Like all champions the Minuteman and Wheelman are a unique blend of power, speed and reliability.

## Contractors Speak Up

*I bought a gas power Wheelman for a contract in NW Washington D.C. It easily mixed 330 bags of Sacrete (80 pound bags). We couldn't pump in Redi-Mix because this contract was located in a very sensitive green area. The Wheelman is a great piece of equipment and it's simple to clean!!!*  
 – Steve Cullen, Owner, Cullen Landscape, Washington D.C.

*Mace, this mixer is great. I thought it would dog mixing my mortar for small remodel jobs; no way! Great product.*  
 – Mike Duke, Owner, Duke Industries, Boca Raton, Florida



## Speed



Mix 200 - 275 lbs. of mortar, stucco, grout, or concrete in less than 4 minutes.

## Gas Power

Working on a jobsite without electrical power, no problem, the Wheelman is available with a 3 h.p. Honda engine.

## Portability

In just a minute, the Minuteman or Wheelman can be “knocked down” into 3 easy to load components. All this by one person, with no tools required!

## Power

The fully enclosed 1/2 h.p. 110v industrial grade motor with direct gear drive provides non-stop performance on any construction project. These mixers truly are Contractor duty!

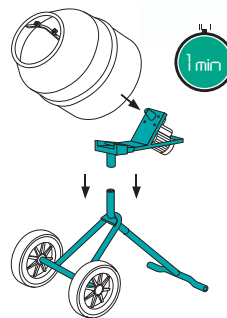

The Poly Drum is available on the Wheelman only.



Optional WHEELMAN stand shown here.

Quick Specs	MINUTEMAN II	WHEELMAN II
Drum capacity	5 cu. ft.	5 cu. ft.
Batch output	275 lbs., 2.5 cu.ft.	200 lbs. 2 cu. ft.
Motor rating	1/2 h.p. 110v/6amp	1/2 h.p. 110v / 6amp
Gas Engine	n/a	Honda 3 h.p.
Drum diameter	24"	24"
Discharge outlet height	21"	8" 21" w/stand
Wheel size	10"	14" pneumatic tires
Weight	120 lbs.	elec. 101 lbs., gas 115 lbs.
<b>OPERATING DIMENSIONS (boxed)</b>		
Length	52" (26")	30" (28")
Height	57" (27")	20,5" (28")
Width	28" (26")	14" (29")